



UVC DISINFECTION SYSTEMS

I. INTRODUCTION

Thank you for purchasing our product and we recommend that you read this user manual carefully before using it. The purpose of this instruction manual is to provide the customer and especially the end user with all necessary information to enable safe and long-term use of our product.



Do not use the device before reading the contents of the manual.

This manual must be available to every user.

A minor may only use the device under the supervision of a competent adult.

Use the device only as directed in these instructions.

The attendant must be in full mental and physical strength

II. GENERAL CHARACTERISTICS AND PURPOSE OF USE

The product is intended for air and surface disinfection. The lamps emit UV-C radiation with a wavelength of 253.6 nm. This radiation quickly eliminates up to 99% of bacteria. The floodlight is efficient, durable, easy to use and maintain, and safe to use while maintaining the SAFETY CONDITIONS OF usage given in this manual.

III. SAFETY WORKING CONDITIONS



Do not use Direct laps with the presence of human and animals - UVC radiation can be harmful to skin and eyes!



The floodlight can only be connected to a grounded power outlet.

A. Do not wash the floodlight with water under pressure or by immersion.

B. All maintenance should be carried out only after disconnecting the floodlight from the power.

C. Floodlight repairs may only be carried out by authorized service technicians using original spare parts.

IV. TECHNICAL DATA

Type	B Direct	B Direct II
Voltage	230V; 50Hz	230V; 50Hz
Isolation class	I (requires electrical grounding)	I (requires electrical grounding)
Light source	1x 55W HO	2 x55W HO
Radiation	253,7nm	253,7nm
Driver		
Power consumption	57W	112W
IP class	IP20	IP20
Coverage area	up to 22 M3	up to 38 M3
Recommended disinfection time	>15 min	>15 min
Weight	5,0 kg	5,3 kg
Size [mm]: height. x width. x depth	940 x135 x 165 mm	940 x135 x 245 mm
Light source life time	9000 H	9000 H

V. CONSTRUCTION AND OPERATION

The bactericidal floodlight consists of the source housing (9), reflector (12), electronics housing (5), radiator (1), ballast (7), mounting bracket (24), mounting bracket (24), cover (13)

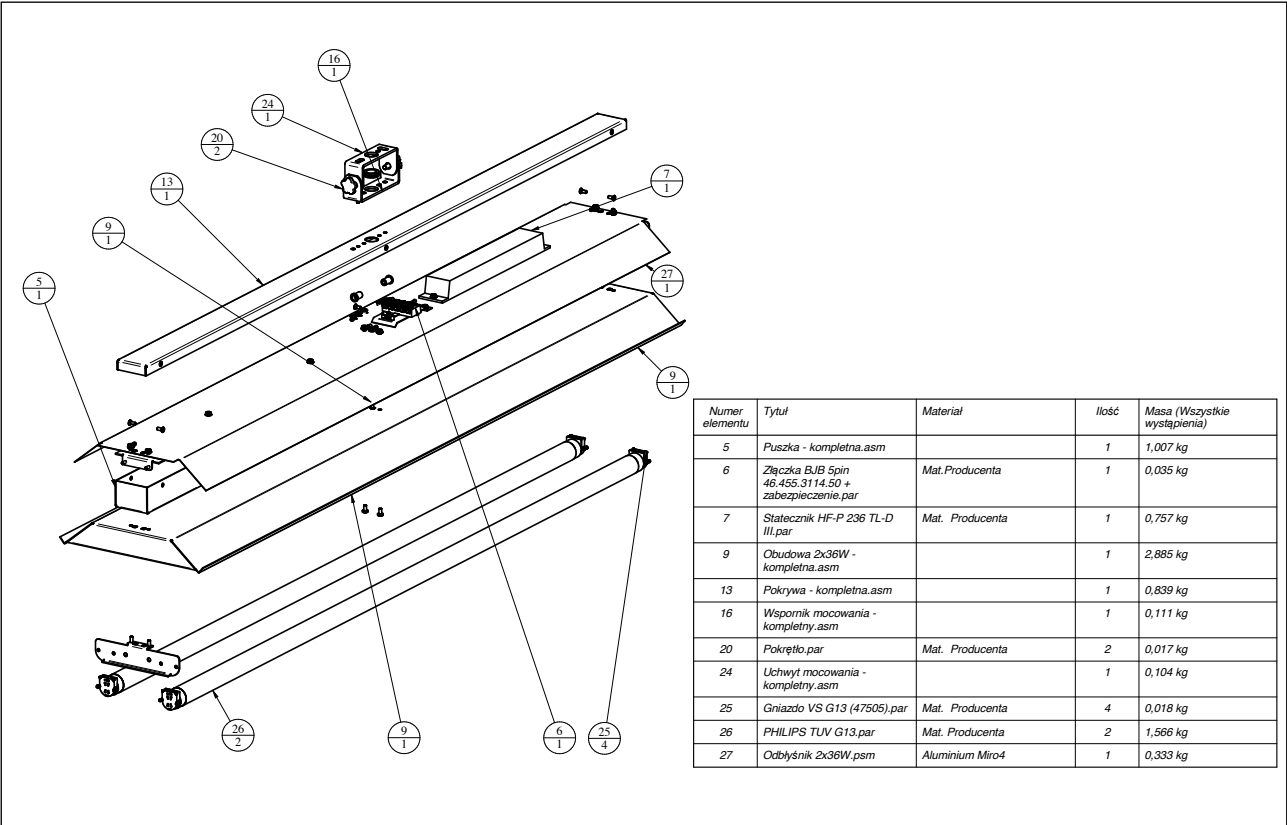
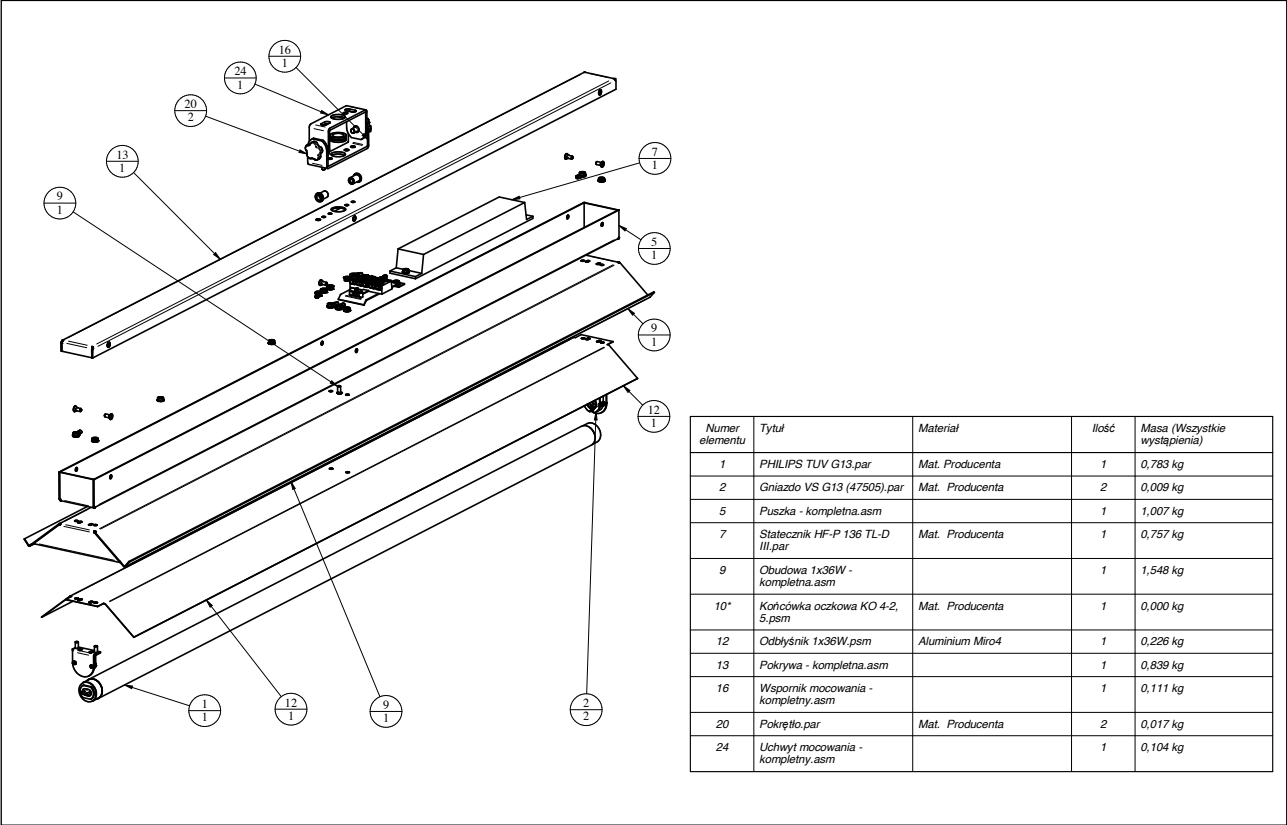

VI. INSTALLATION AND START-UP

The floodlight is attached to a flat surface by means of mounting pins, near electrical wires with grounding, which should be connected to the connector supply. (see assembly diagram).



When connecting the cables to the connector, the power cables must not be ON.



Electrical installation must be carried out correctly by authorized electricians



**B DIRECT
B DIRECT II**

Instrukcja montażu
Installation instructions
Instructions de montage
Montageanleitung

IP20

220-240 V
50-60 Hz

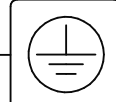

Dimensions

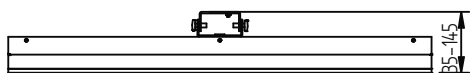
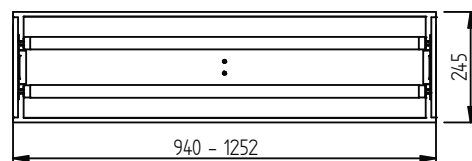
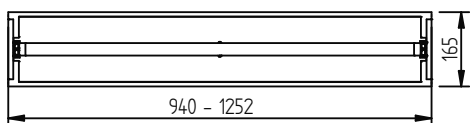

Ceiling mount

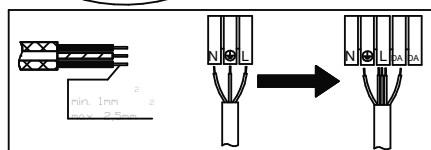
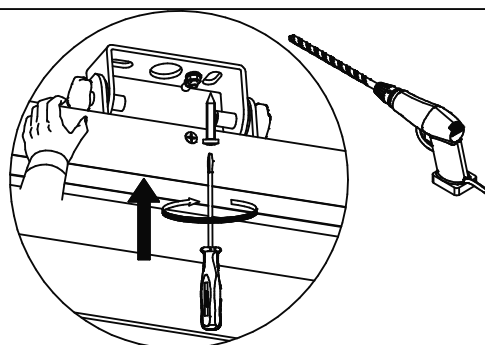
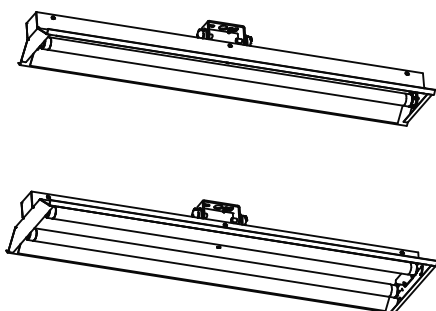

PL - Rozłączyć zapłon przed wymianą lampy.
UK - Disconnect the unit before changing the lamp.
F - Debrancher l'appareil avant de changer la lampe.
D - Von den Auswechseln der lampe die Leuchte von der Netzspannung trennen.

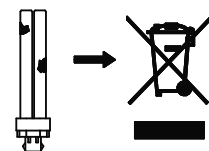



The electrical installation must have a floodlight switch in a place inaccessible to unauthorized persons and in another room to limit exposure to negative radiation when turning on the floodlight.

VII. CLEANING AND MAINTENANCE

To ensure proper work efficiency, keep the floodlight clean. Always disconnect power before cleaning the floodlight. External surfaces should be cleaned with a soft cloth and non aggressive cleaning agents.



Do not clean the floodlight with water under pressure or with pressure washers.

VIII. REPLACEMENT OF UV LAMP

To ensure proper work efficiency, keep the floodlight clean. Always disconnect power before cleaning the floodlight. External surfaces should be cleaned with a soft cloth and non aggressive cleaning agents.



Before replacing the sources, turn off the voltage in the electrical system

1. Carefully grasp the glass bulb of the source (use cotton gloves), rotate it about 90° around the axis and remove from the holders.
2. Insert the new lamp with the dowels into the slots of the holders and rotate it about 90° around the axis.



Due to drop of bactericidal parameters, lamp replacement must be carried out after every 9000 hours of lamp operation.

IX. REPAIR

All types of repairs can only be carried out by Luxibel.

For repair options or specific inquiries, please contact our Service Department